

NEW

Partel 

ALMA

THERM

100 % RECYCLED PANEL FOR HI-PERFORMANCE STRUCTURAL INSULATION

An innovative PET-based panel, this **NEW** sustainable alternative to conventional construction materials meets the highest technical and ecological standards for reducing thermal bridges. Owing to its versatility, being lighter, more compact and with a lower thermal conductivity, this product is designed to improve the energy efficiency of the building.

CE

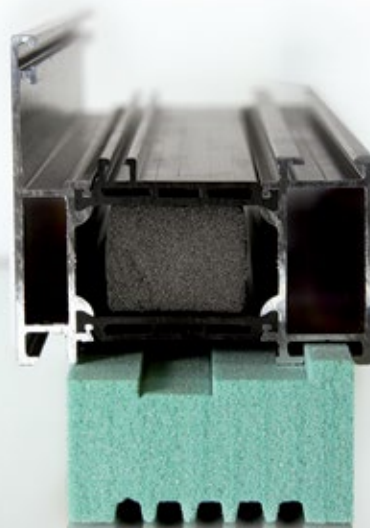
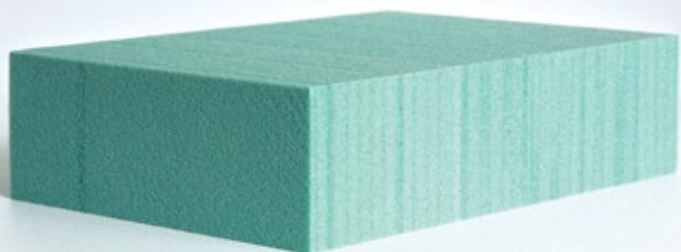

ALMA THERM

MATERIAL COMPLIANT WITH THE NEW ENERGY CODES

The raw material consists of production waste from PET bottles. Once the product has completed its useful life, it can be recycled again.

the material is free of emissions during installation and later use.

ALMA THERM meets all the conditions required to be installed in low-energy building projects.

Numerous tests have confirmed that

KEY ADVANTAGES, ALL IN ONE PANEL—STRENGTH, INSULATION, PROTECTION



Highly efficient thermal break



Excellent mechanical strength



High compressive strength



Permeable to water vapor diffusion



Excellent thermal conductivity / R-value



Lightweight composite structure



Low water absorption



Environmentally-friendly core material (100% recyclable)

| PROPERTIES | PANEL DENSITY | | UNIT | STANDARD |
|--|---------------|---------|-------------------|----------|
| | 115 | 180 | | |
| COMPRESSIVE STRENGTH (PERPENDICULAR) | 1.5 | 3.2 | N/MM ² | EN 826 |
| E-MODULUS COMPRESSION (PERPENDICULAR) | 67 | 118 | N/MM ² | EN 826 |
| THERMAL CONDUCTIVITY | 0.036 | 0.043 | W/ (M . K) | EN 12667 |
| SD VALUE | 16.8 | 38.3 | S _d | EN-1931 |
| BUILDING MATERIAL CLASS / FIRE BEHAVIOR | E | E | - | EN 13501 |
| ABSORPTION OF WATER (AFTER 7 DAYS WATER STORAGE) | CA. 2,0 | CA. 2,0 | VOL.-% | INTERNAL |

CHOOSE THE RIGHT PANEL FOR YOUR PROJECT

ALMA THERM is manufactured in two different density classes 115 kg/m³ and 180 kg/m³.

STANDARD DIMENSIONS

1218 X 1005 X 50MM
(4' X 3' 4" X 2")

1218 X 1005 X 75MM
(4' X 3' 4" X 3")

*Other dimensions are available on request

REAL FACTS

- ✔ 25 X 1.5 L PET BOTTLES PRODUCE 4.5 x 35 x 35 cm / 1' x 1' x 2" ALMA THERM BOARD



FIELDS OF APPLICATION

- ✔ Internal and external use
- ✔ Thermal separation
- ✔ Thermal bridge - free installation of all building elements, according to DIN4108

